

VFD-RSI-250-H2-4C ON DWG

Item	Voltage / Phase	Normal Duty Rating	Normal Duty Amps	Heavy Duty Rating	Heavy Duty Amps	Weight	Heat Loss(W)	UL/IP RATING
VFD-RSI-250-H2-4C	460V / 3φ	250HP / 160kW	325.0A	200HP / 132kW	255.0A	164.7lb / 74.7kg	5600	UL OPEN / IP20

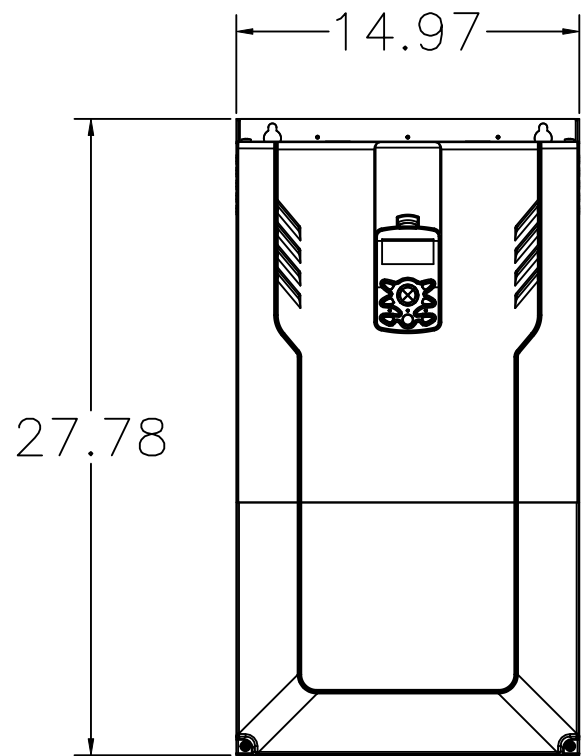

FRONT VIEW

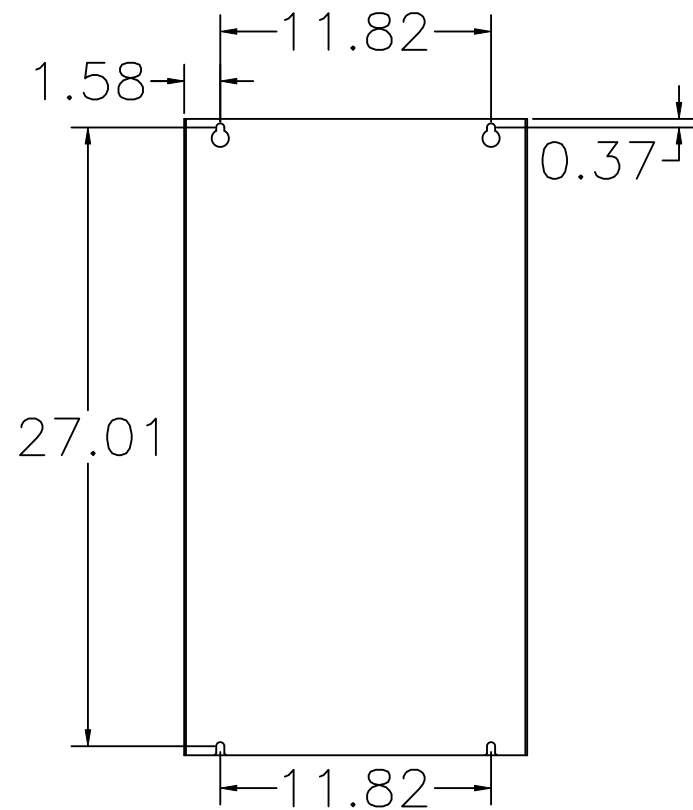

BACK VIEW

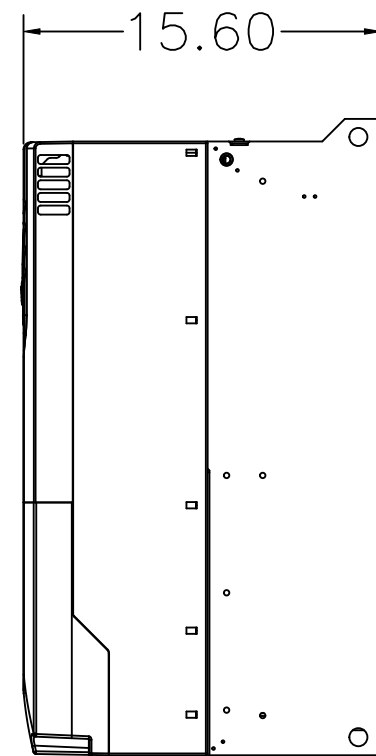

RIGHT SIDE VIEW

HP	Input / Output Terminal Screw Size	Input / Output Screw Torque
250	M12	17.87 ~ 21.07 Nm 53 ~ 80 lbf.in
300		

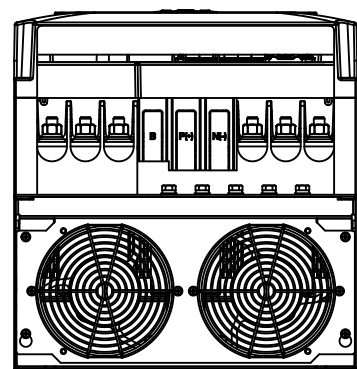
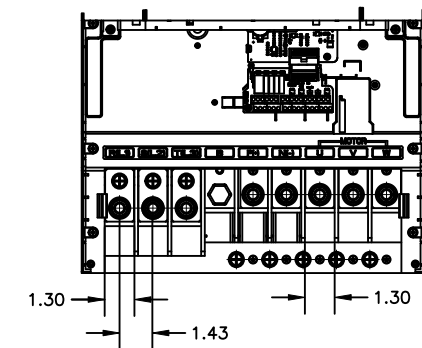

BOTTOM VIEW

NOTES:

- * HD: Heavy duty type for constant torque load 150%P* ND: Normal duty type for variable torque load 110%P* Heatloss is measured with 60Hz, 100% load and default carrier frequency.
- * Refer to product manual for additional details and specifications
- * UL Type 1 is achieved with optional conduit box. P/N EN-101040-06

REVISIONS DO NOT SCALE DWG	THIRD ANGLE PROJECTION	UNLESS OTHERWISE SPECIFIED ALL DIMENSIONS IN INCHES INTERPRET DRAWING PER ASME Y14.5M-1994 TOLERANCES: .XX ± .03 .XXX ± .015 ANGLES ± 1°	TITLE: H2 SERIES VFD 250HP, 480V, 325A, ND 200HP, 480V, 255A, HD UL OPEN (IP20)	SIGNATURES: R,J,F DATE: 04/02/20 CHKD: DRP 11/17/20 ENG: DRP 01-10-22 MFG: SIZE: D DWG NO.: SCALE: 1:1	615 ALPHA DRIVE PITTSBURGH, PA. 15238 BENSHAW 550 BRIGHT STREET LISTOWEL, ONTARIO M4W 3W3	REV: 0 SHEET 1 OF 1
	THIS DRAWING AND ALL INFORMATION CONTAINED HEREIN, IS THE PROPERTY OF BENSHAW INC. AND MAY NOT BE REPRODUCED, OR DIVULGED TO UNAUTHORIZED PERSONS WITHOUT THE EXPRESS WRITTEN CONSENT OF BENSHAW INC. IT IS PROVIDED SOLELY FOR THE CONVENIENCE OF THE USER AND SHALL BE RETURNED UPON REQUEST.			VFD-RSI-250-H2-4C		