

R2LR450-43C

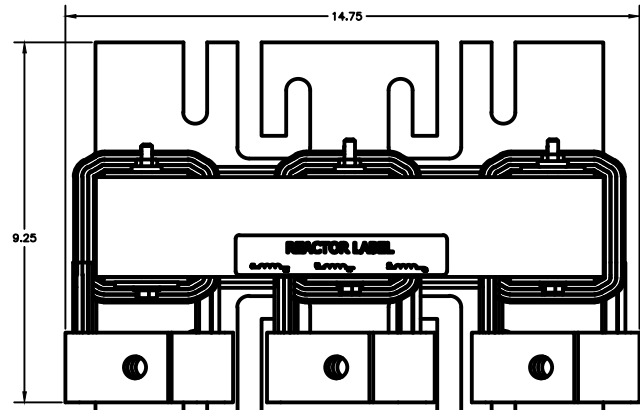

Top View

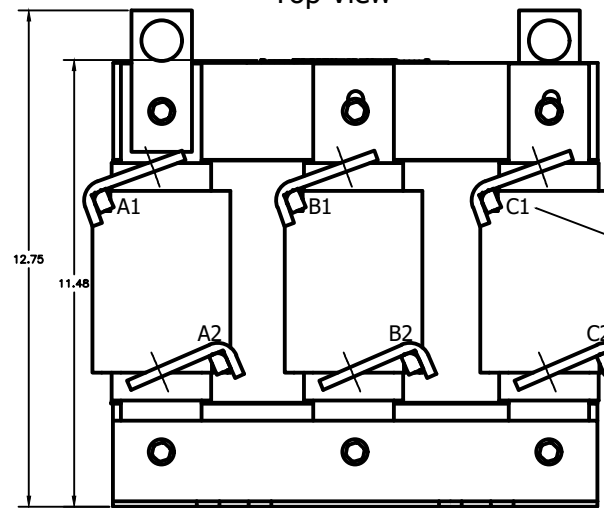

Front View

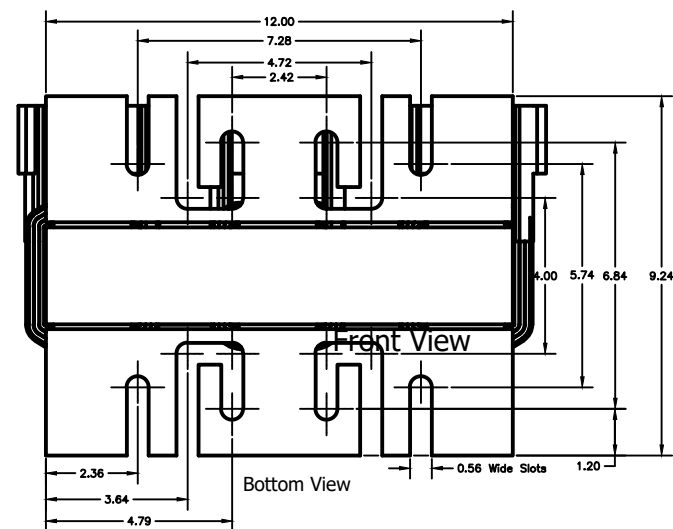

Bottom View

480 V, 600 V Max. Low Z								
Part Number	Horsepower (HP)	Motor Amps (A)	Maximum Amps (A)	Inductance (uH) +/-10%	Weight (lbs)	Losses (W)	Lug Kit	Bus Hole Dia.
R2LR450-43C	450	515	610	36.30	110	509	14	0.53

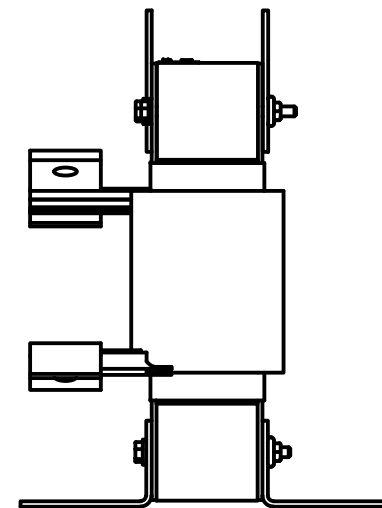

Side View

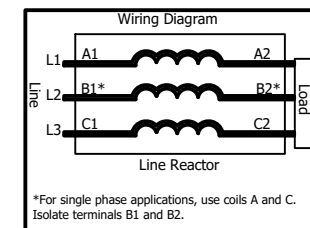
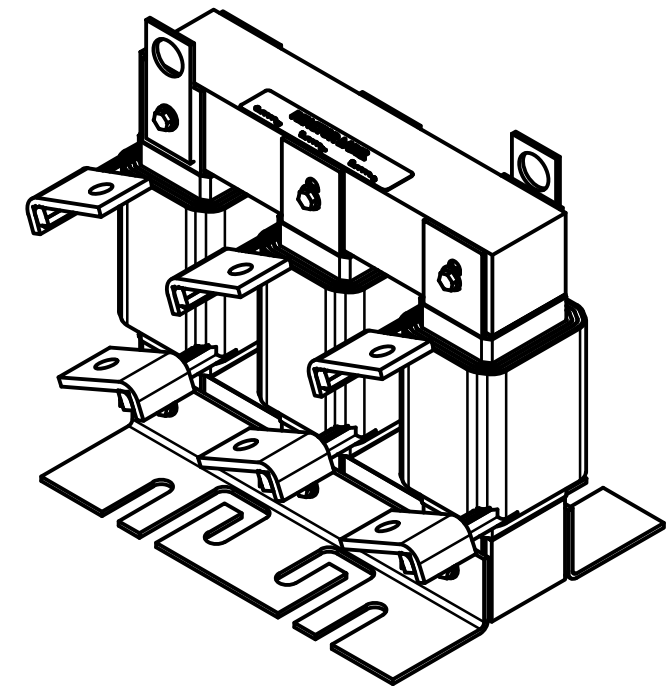

- Notes: 1. Installation Instructions: Manual Part Number 890059-00-00.  
 2. Customer Is Responsible For Installation To Meet All National And Local Electrical Codes.  
 3. Lug Kits sold separately.

REVISIONS DO NOT SCALE DWG	THIRD ANGLE PROJECTION	UNLESS OTHERWISE SPECIFIED ALL DIMENSIONS IN INCHES INTERPRET DRAWING PER ASME Y14.5M-1994 TOLERANCES: .XX ± .03 .XXX ± .015 ANGLES ± 1°	TITLE: LINE REACTOR 3% IMPEDANCE 480V, 450 HP, 515 A OPEN		SIGNATURES DRP: DRP 08/17/22	DATE 08/17/22	615 ALPHA DRIVE PITTSBURGH, PA. 15238 550 BRIGHT STREET LISTOWEL, ONTARIO M4W 3W5
	THIS DRAWING AND ALL INFORMATION CONTAINED HEREIN IS THE PROPERTY OF BENSHAW INC. AND MAY NOT BE REPRODUCED, OR DIVULGED TO UNAUTHORIZED PERSONS WITHOUT THE EXPRESS WRITTEN CONSENT OF BENSHAW INC. IT IS PROVIDED SOLELY FOR THE CONVENIENCE OF THE USER AND SHALL BE RETURNED UPON REQUEST.		MATERIAL: FINISH:	SIZE D	DWG NO. R2LR450-43C	REV 0	
	SCALE: NTS			SHEET 1 OF 1			