

MX4PB-HD-500-4-4-HB

NOTES:

- 1 MINIMUM WIRE BENDING SPACE SHALL BE 16.00" FROM TOP OF CIRCUIT BREAKER POWER CONNECTION TO TOP OF ENCLOSURE.
- 2 ENSURE THAT ALL RIBBON CABLES ARE ROUTED AWAY FROM POWER CONDUCTORS.
- 3 MINIMUM WIRE BENDING SPACE SHALL BE 16.00" FROM BOTTOM OF POWERSTACK POWER CONNECTION TO BOTTOM OF ENCLOSURE.
- 4 ENCLOSURE LAYOUT IS DESIGNED FOR CABLE ENTRY/EXIT TO BE TOP/BOTTOM.

LABEL LEGEND

- CB1: CIRCUIT BREAKER
- DIS: EMX4I LCD DISPLAY/KEYPAD
- GND: GROUND LUG
- LVSS: EMX4I SOFT START (W/INTEGRAL BYPASS)
- TB1: TERMINAL BLOCKS
- CR1-2: CONTROL RELAYS
- T1: CONTROL POWER TRANSFORMER
- FU4-FU5: PRIMARY FUSES (T1)
- FU6: SECONDARY FUSE (T1)

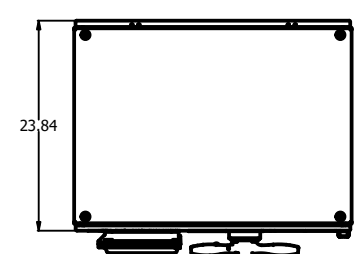

TOP VIEW

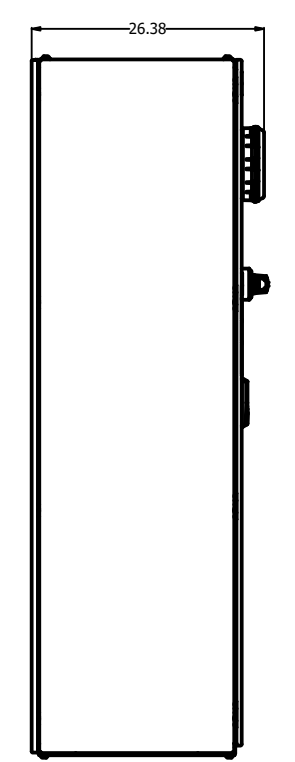

LEFT SIDE

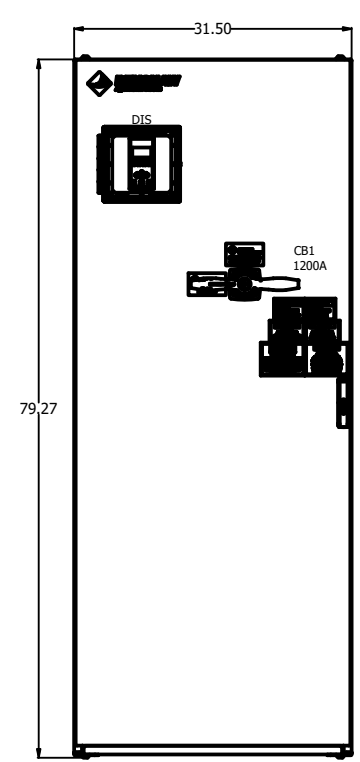

FRONT VIEW

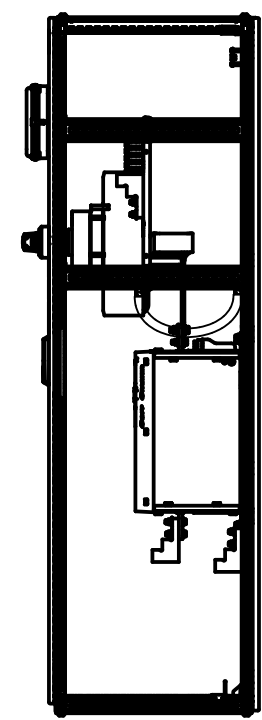

RIGHT SIDE

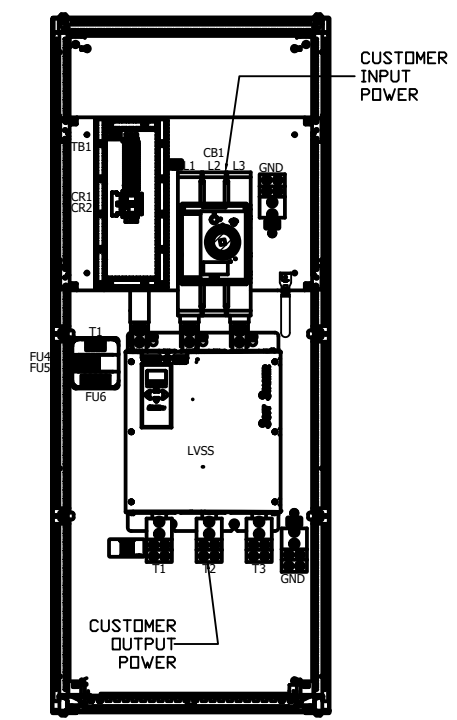

PANEL VIEW

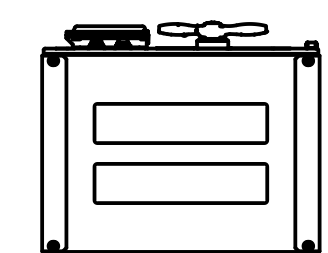

BOTTOM VIEW

OPTIONS AND CODE NUMBERS			
OPTION CODE NO.	DISPLAY	HEATER	CONTROL
	YES		

APPROVED: _____ CHG BY: _____ CHANGE: _____	REVISIONS DO NOT SCALE DWG	THIRD ANGLE PROJECTION	UNLESS OTHERWISE SPECIFIED ALL DIMENSIONS IN INCHES INTERPRET DRAWING PER ASME Y14.5M-1994 TOLERANCES: .XX ± .03 .XXX ± .015 ANGLES ± 1°	TITLE: ENCLOSURE LAYOUT MODULAR REDUCED VOLTAGE SOLID STATE STARTER NEMA 3R/12 WITH INTERNAL BYPASS	SIGNATURES: _____ DATE: 03/26/21	615 ALPHA DRIVE PITTSBURGH, PA. 15236 BENSHAW 550 BRIGHT STREET LISTOWEL, ONTARIO N4W 3M5	DRWN: MSN 03/26/21 CHKD: BDA 03/26/21 ENG: MSN 03/26/21	SIZE: D DWG NO.: MX4PB-HD-500-4-4-HB	REV: 0
		THIS DRAWING AND ALL INFORMATION CONTAINED HEREIN IS THE PROPERTY OF BENSHAW INC., AND MAY NOT BE REPRODUCED OR DIVULGED TO UNAUTHORIZED PERSONS WITHOUT THE EXPRESS WRITTEN CONSENT OF BENSHAW INC. IT IS PROVIDED SOLELY FOR THE CONVENIENCE OF THE USER AND SHALL BE RETURNED UPON REQUEST.			MATERIAL: _____ FINISH: _____		SCALE: 1:10	SHEET 1 OF 2	

